

发行版本 Revision	修改内容 Description	制图 Drawing	日期 Date
A / 0	First release	Ding	2023.06.02

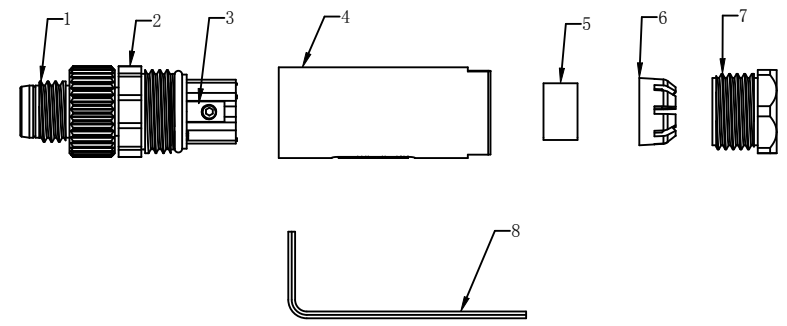
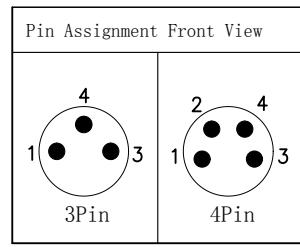
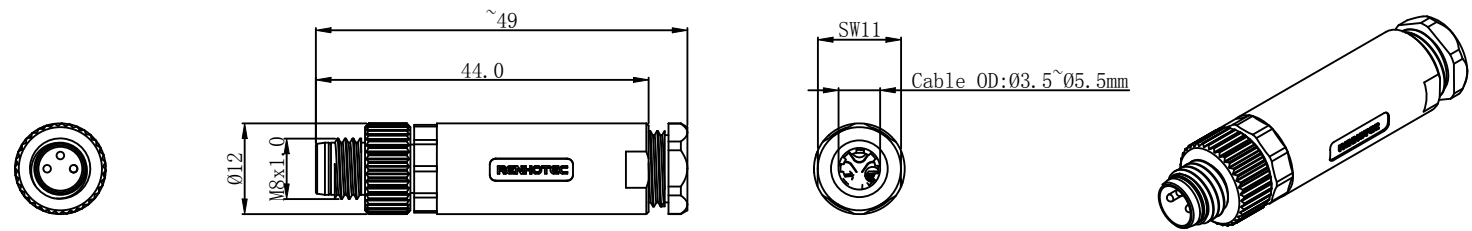

NOTES:

- Rated voltage/current : 3pin: 60V/3A  
4pin: 60V/3A
- Wire Range :  
3pin: 24-22AWG/0.25~0.34mm<sup>2</sup>  
4pin: 24-22AWG/0.25~0.34mm<sup>2</sup>
- Cable Range: Ø03.5~Ø5.5mm
- Wire connection mode: Screw
- Operating temperature: -40°C ~+85°C
- RoHS Compliance

8	Hex key	Carbon Steel	1	PCS
7	Pressure Screw	PA66 UL94-V0	1	PCS
6	Pinch ring	PA66 UL94-V0	1	PCS
5	Seal	NBR, Black	1	PCS
4	Body	PA66 UL94-V0	1	PCS
3	Contact	Brass with gold plated	3-4	PCS
2	Insert	PA66 UL94-V0	1	PCS
1	Screw	Brass with nickel plated	1	PCS
编号 No.	品名 Part Name	描述 Description	单位 Unit	用量 Qty

客户料号 Cus' P/N	图号 File No.	RHT-634-3368	品名 Name	M8 Male connector Assembly, Screw joint
未注公差 Unless Otherwise Specified		单位 Unit	mm	版本 Revision
		mm	A/0	日期 Date
线性 Linear	0.5~6 ±0.1 >6~30 ±0.2 >30 ±2%	比例 Scale	--	日期 Date
角度 Angles	±3°	页码 Page	1/1	日期 Date
		 Third Angle Projection		日期 Date
				审核 Checked
				客户确认 Customer Approved